

Dr Zechmann's

PICO Dressing Instructions



Introduction

The dressing you have over your incision is a type of negative pressure bandage. What does this mean? This type of dressing has a battery operated pump that sucks the air out of the dressing and this helps stimulate drainage. This is not a drain that is inside of your incision, merely a fancy bandage that is meant to help you have the best possible outcome and prevent fluid collection under the skin.

Dressing care

This dressing should be in place for at least a week and should not be submerged in water. You may shower with this dressing in place, just avoid direct spray and gently pat dry. No need to disconnect the pump while showering. Most of these pumps include a belt clip for easy wear; If not, if it's easily into your pocket.

Problem shooting

The pump should work about a week, but some problems may arise. If the pump alarms, the image below demonstrates what is wrong with the bandage. If it has only been a few days since surgery and the dressing is saturated, please contact our clinic for further instructions. If it has been around a week and the bandage is saturated, you may change to a new dressing that does not need a pump. If the pump stops working and dressing is not saturated, you may tie off the tube close to the dressing and cut the remaining tubing off.

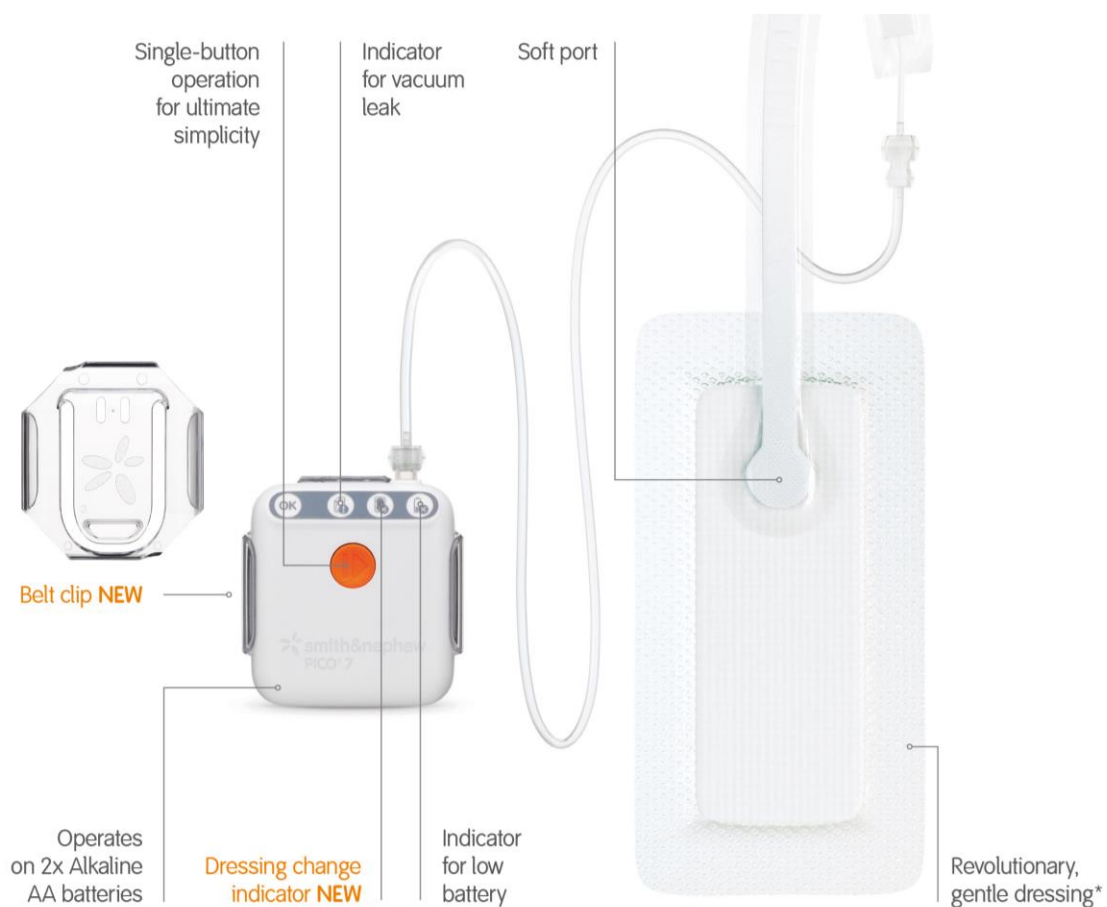

As a reminder, drainage for the first week after surgery is normal. If drainage persists longer than a week please contact Dr. Zechmann's office to set up an appointment to be seen.

Please let us know if there is anything we can do to make your recovery easier!